

## Features

- Flex Saver Easy is able to hold up to 4 hydraulic hoses (depending on the diameter) and to guide them with a possibility to rotate from the hydraulic kit on the tractor to the connected trailer. The guide avoids premature wear of hoses.
- Mounting is simple; slotted holes with clamp plates enable the guide to be fitted to any chassis without welding.
- The guide arm is robust and partially manufactured in high tensile steel. The guide arm is electrolytically zinc-plated as anti-corrosion protection.

## Specifications

Chassis widths	495 < 710 mm
Weight	11 kg
Torque setting M12x50	Max. 50 Nm
Torque setting M8x50	Max. 10 Nm.
Torque setting M12	Max. 50Nm

## Assembly

1. Mount the top part on the base part: the disc should be on top of the base part; the washers, spring and nut below the base part.
2. Tighten the primary nut so that the arm can still pivot (but with some resistance).
3. Tighten the extra locknut against the primary nut with a torque of 50Nm.

## Installation

1. Manoeuvre the guide arm diagonally between the truck chassis frame.
2. Determine the position of the guide arm correctly:
  - a. Make sure that once the hoses are fitted the tractor can steer freely without pulling or crushing the hoses.
  - b. Check if the guide arm can't touch any components on the tractor (e.g.fuel tank gauge, return filter, filler cap).
3. Fasten the clamps under the chassis frame by tightening the 4 bolts (max. torque: 50Nm), ensure the clamps are at least 15mm on each side under the chassis frame.
4. Place the hose(s) into the guide arm and tighten the M8 bolts (max. torque: 10Nm), so the plates hold the hose(s) in place.

## Options

- If the guide arm is touching any components, add spacer kit 14801115 to increase the height to total of 70mm.
- Use the 4 holes (dia. 35mm) in the base part for mounting bulkheads.
- Use the slotted holes in the top part for clamping additional hoses with tie-wraps.

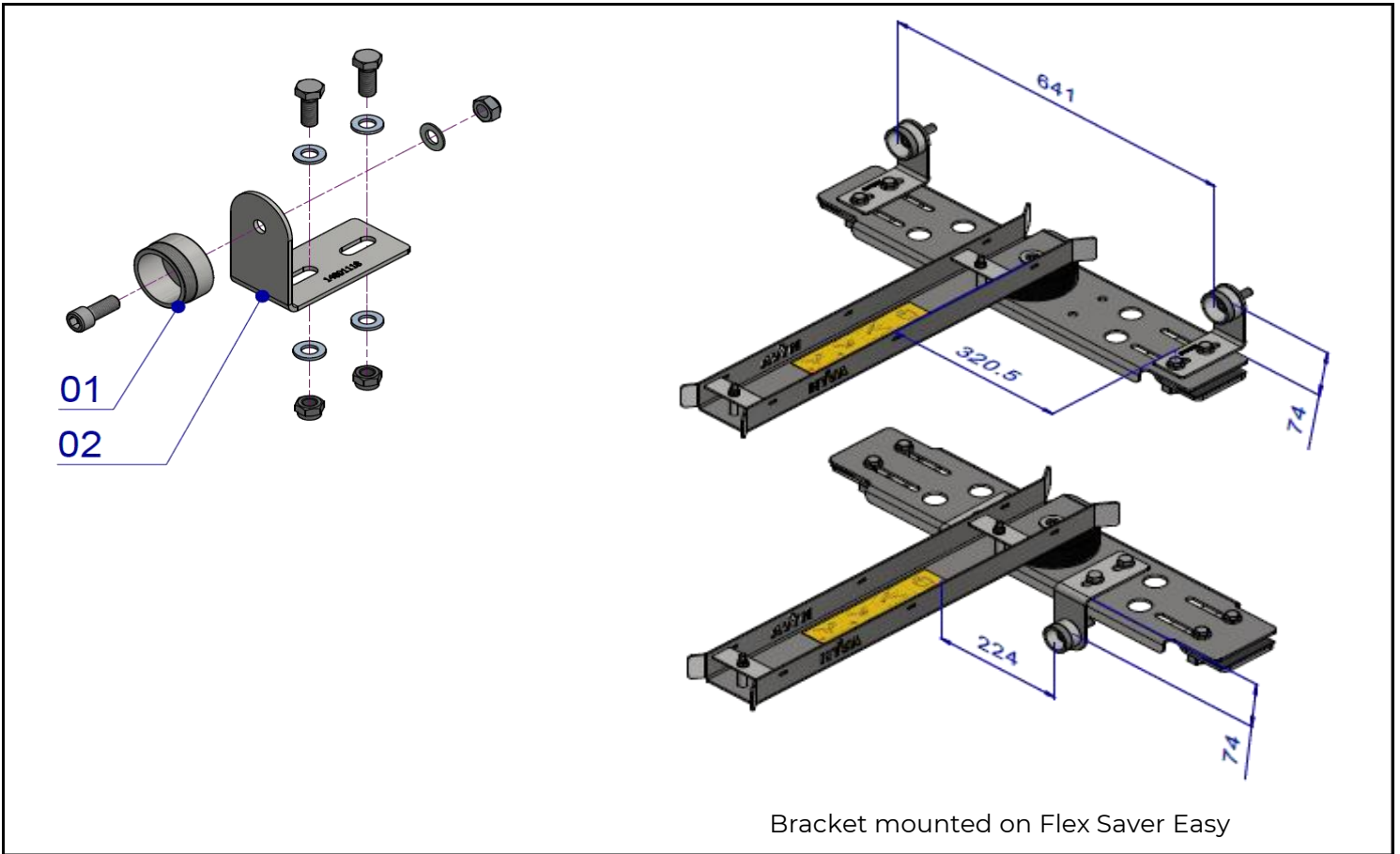
**FEMALE QUICK RELEASE COUPLING**

Bracket mounted on Flex Saver Easy

No.	Part no.	Description	No.	Part no.	Description
1	14785406	retainer BSP 3/4" (for 01332650 or 01332600)	2	14801118	Mounting bracket + fastener kit
1	14785405	retainer BSP 1" (for 01332625)			QR Mounting kit:
					- Mounting bracket (x1)
					- Bolt M12x45 (x1)
					- Hex. Head bolt M12x30 (x2)
					- Hex. Locking nut M12 (x2)
					- Hex. Nut M12 (x2)
					- Plain washer M12 (x5)

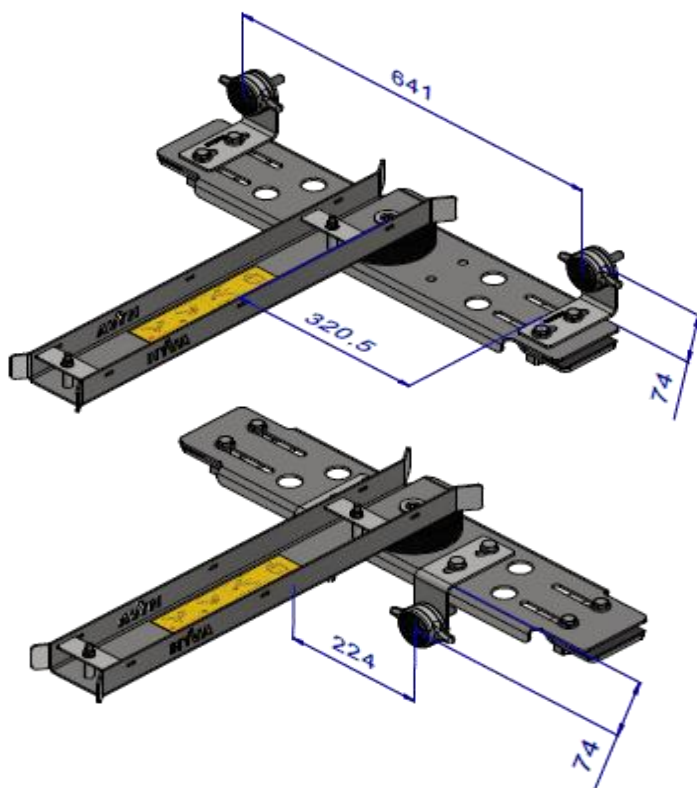
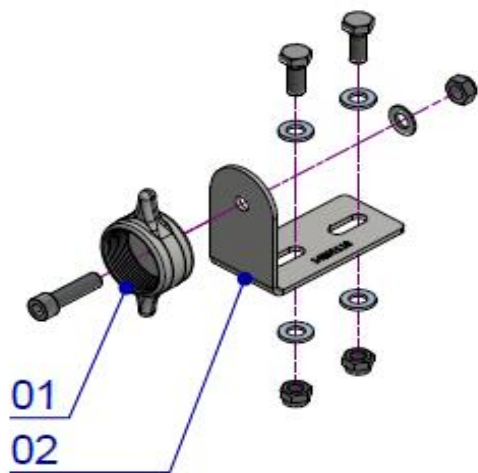
**MALE QUICK RELEASE COUPLING**

Bracket mounted on Flex Saver Easy

No.	Part no.	Description	No.	Part no.	Description
1	01332621	wing nut 3/4" + spacer (for 01332605 or 01332655)	2	14801118	Mounting bracket + fastener kit
1	01332646	wing nut 1" + spacer (for 01332630)			QR Mounting kit:
					- Mounting bracket (x1)
					- Bolt M12x45 (x1)
					- Hex. Head bolt M12x30 (x2)
					- Hex. Locking nut M12 (x2)
					- Hex. Nut M12 (x2)
					- Plain washer M12 (x5)